

REV.	DESCRIPTION	ECN	DATE
C	INITIAL RELEASE	1120_ER6904	4-30-20

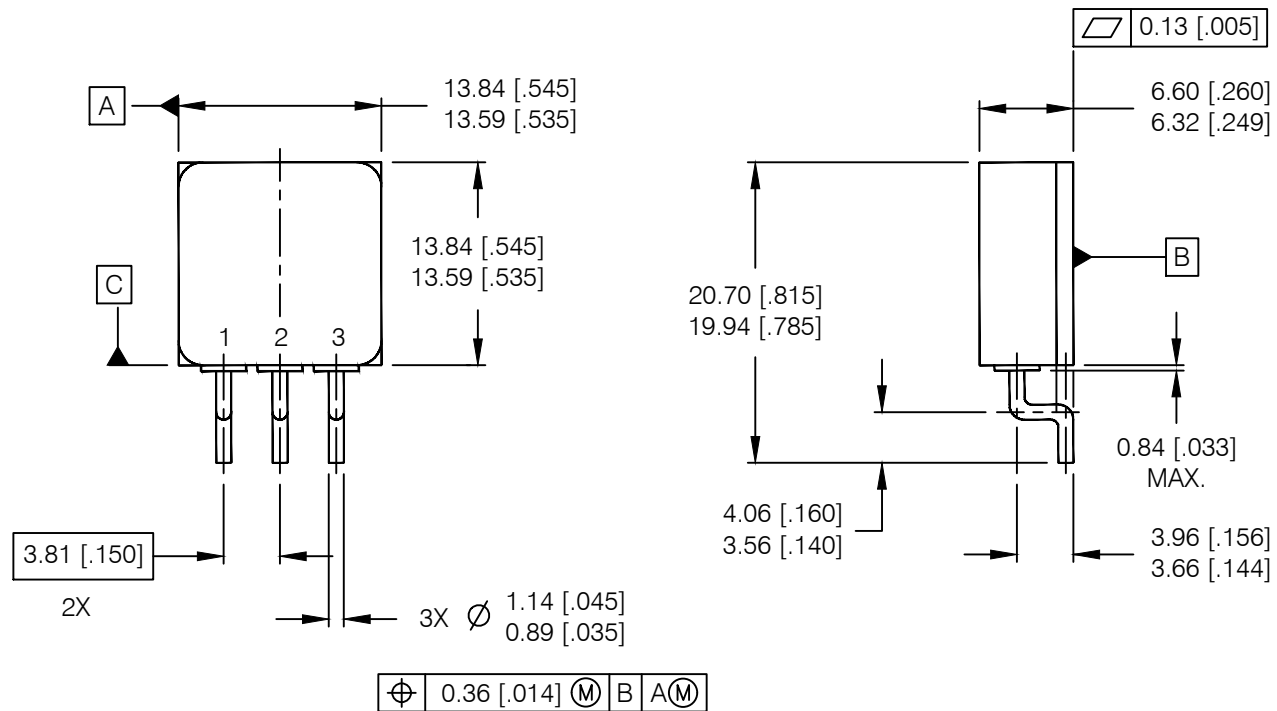

NOTES:

1. DIMENSIONING & TOLERANCING PER ASME Y14.5M-1994.
2. ALL DIMENSIONS ARE SHOWN IN MILLIMETERS [INCHES].
3. CONTROLLING DIMENSION: INCH.
4. THIS OUTLINE IS A MODIFIED TO-254AA JEDEC OUTLINE.
5. FINAL LEAD FINISH IS SOLDER ALLOY 63%Sn 37%Pb.
6. STANDARD FINAL FINISH ON ALL TERMINALS IS SOLDER ALLOY 63%Sn 37%Pb.

SURFACE MOUNT DEVICE:
LEADS SHALL BE MAINTAINED
FOR COPLANARITY.

IOR HiRel
An Infineon Technologies Company

TITLE: TO-254AA TABLES,
STD & LOW OHMIC, SURFACE MOUNT
LEADFORM, PACKAGE OUTLINE

DRAWING NO.
D100746G-WEB

REV C