



**Please note that Cypress is an Infineon Technologies Company.**

The document following this cover page is marked as “Cypress” document as this is the company that originally developed the product. Please note that Infineon will continue to offer the product to new and existing customers as part of the Infineon product portfolio.

**Continuity of document content**

The fact that Infineon offers the following product as part of the Infineon product portfolio does not lead to any changes to this document. Future revisions will occur when appropriate, and any changes will be set out on the document history page.

**Continuity of ordering part numbers**

Infineon continues to support existing part numbers. Please continue to use the ordering part numbers listed in the datasheet for ordering.

REVISIONS

PAGE	ZONE	REV	ECN	DESCRIPTION	DATE	APPROVED
1	-	**	50551	NEW RELEASE	06/06/97	
1	-	*A	104843	ADD TOLERANCE ON DIM. A0, B0, K0, K1	01/10/01	
1	-	*B	127264	Change title from 28LD SOJ Carrier tape (300 mil) to Carrier tape, SOJ 28 (300 mil). Complete revision on drawing, notes and Ao/Bo dimensions.	5/23/03	
1	-	*C	3285739	UPDATED DRAWING CHANGE DRAWING TEMPLATE	06/29/11	
1	-	*D	4447918	UPDATE DRAWING TEMPLATE	07/18/14	

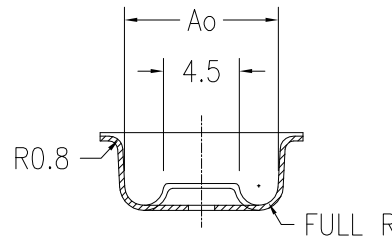
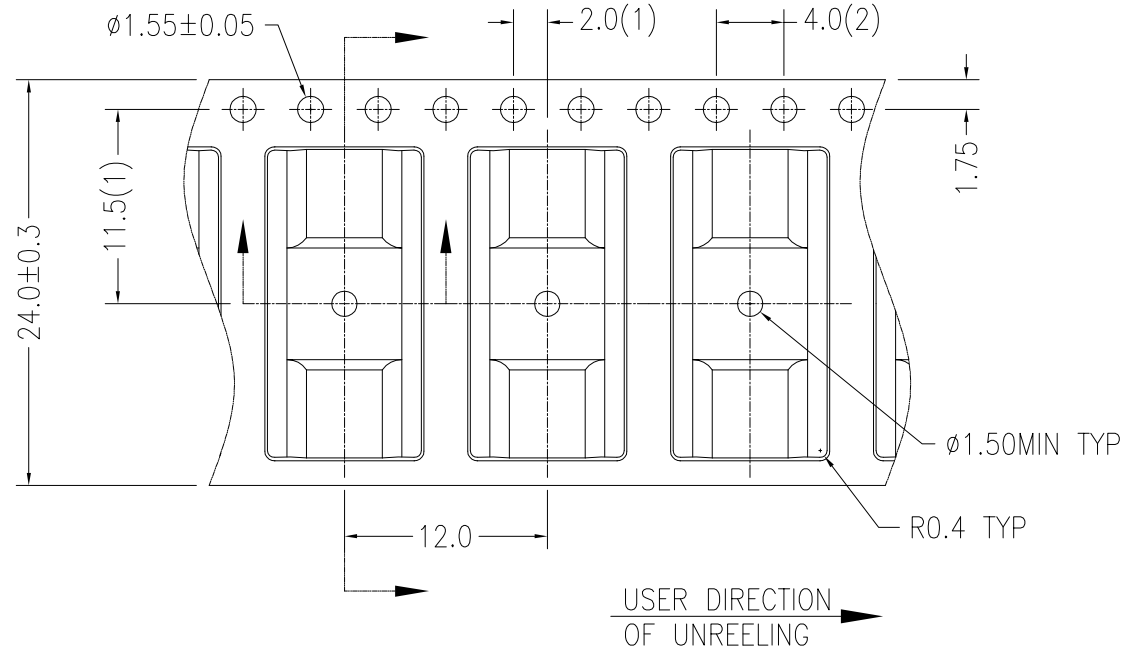
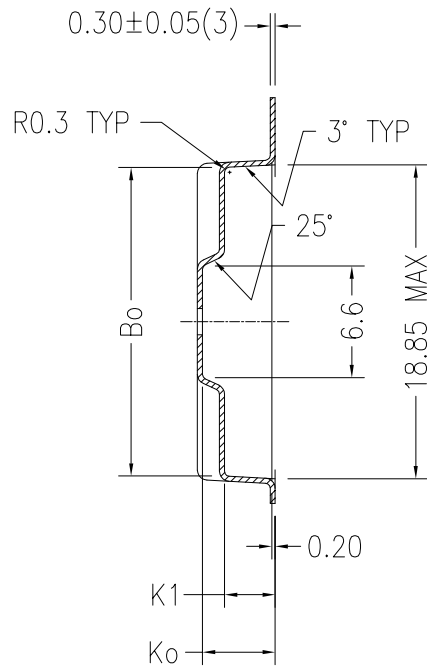

$A_0 = 9.10 \pm 0.1$   
 $B_0 = 18.25 \pm 0.1$   
 $K_0 = 4.30 \pm 0.1$   
 $K_1 = 3.00 \pm 0.1$

NOTES:

- (1). MEASURED FROM THE CENTERLINE OF SPROCKET HOLE TO CENTERLINE OF THE POCKET HOLE AND FROM THE CENTERLINE OF SPROCKET HOLE TO CENTERLINE OF THE POCKET
- (2). CUMULATIVE TOLERANCE OF 10 SPROCKET HOLES IS  $\pm 0.20$
- (3). THIS THICKNESS IS APPLICABLE AS MEASURED AT THE EDGE OF THE TAPE
4. MATERIAL: CONDUCTIVE POLYSTYRENE
5. ALL DIMENSIONS ARE IN MILLIMETERS
6. ALLOWABLE CAMBER TO BE 1mm PER 100mm IN LENGTH, NON-CUMULATIVE OVER 250mm
7. UNLESS OTHERWISE SPECIFIED, TOLERANCE  $\pm 0.10$
8. SURFACE RESISTIVITY FROM  $1.0 \times 10^5$  TO  $1.0 \times 10^{11}$  OHMS/SQ.

UNLESS OTHERWISE SPECIFIED		DESIGNED BY	DATE	
ALL DIMENSIONS ARE IN MILLIMETERS STANDARD TOLERANCES ON: DECIMALS $\pm 0.10$ .XX $\pm 0.10$ .XXX $\pm 0.100$ .XXXX $\pm 0.1000$ ANGLES $\pm 1.0$		DRAWN <b>XVC</b>	DATE <b>07/18/14</b>	
		CHK BY <b>ECVI</b>	DATE <b>07/18/14</b>	TITLE <b>CARRIER TAPE ,SOJ 28 (300 MIL)</b>
		APPROVED BY <b>QAD</b>	DATE <b>07/18/14</b>	SIZE <b>A</b>
MATERIAL <b>SEE NOTE</b>		APPROVED BY <b>UYO</b>	DATE <b>07/18/14</b>	PART NO. <b>V28.3CT</b>
FINISH <b>SEE NOTE</b>				DWG NO. <b>51-51064</b>
				REV <b>*D</b>
				DO NOT SCALE
				SHEET 1 OF 1